

ICEBERG 2

ISOMETRIC OF STRUCTURE

PLAN VIEW

ISOMETRIC VIEW 4

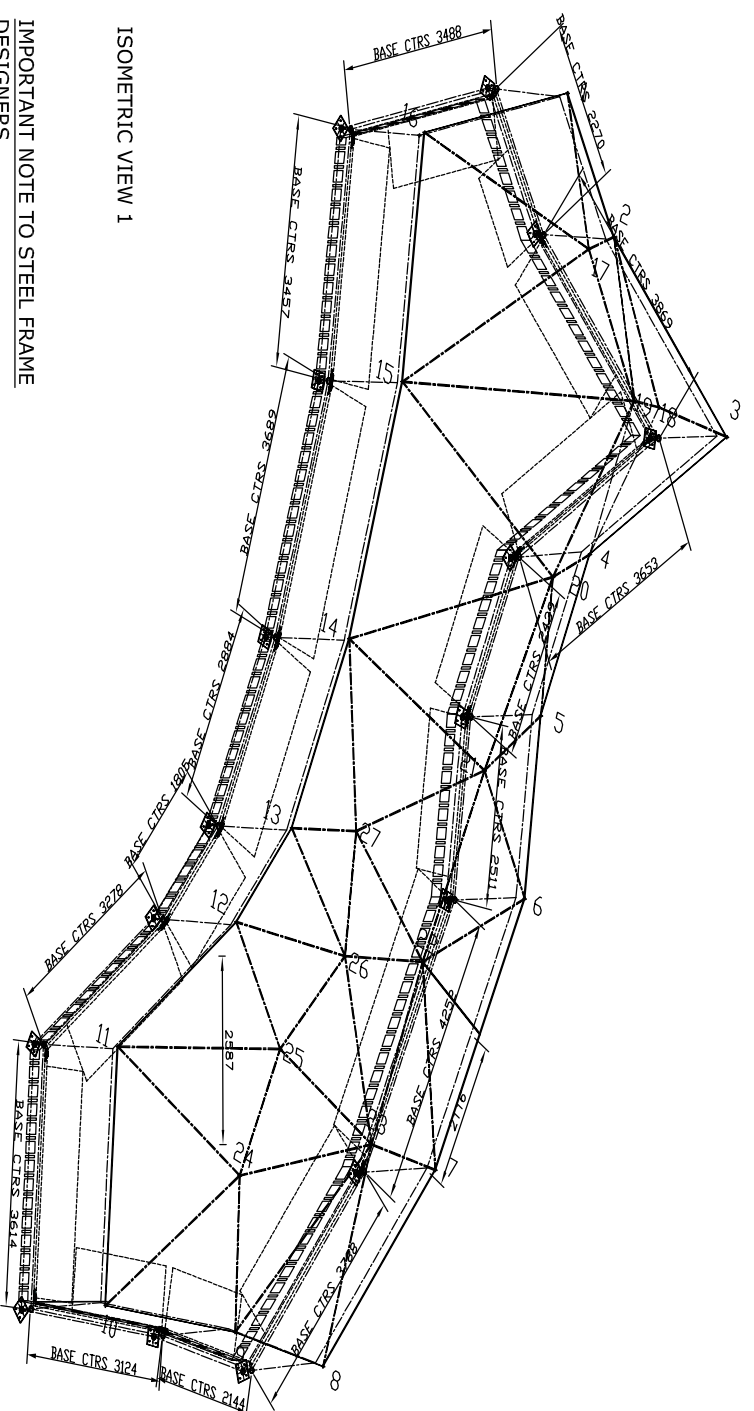

IMPORTANT NOTE TO STEEL FRAME DESIGNERS.
GLASS PLANE IS BASED ON THE NODE COORDINATES TO THE INTERSECTION CHORDS. TO THE OUTER FACE OF THE GLASS.
THE STEEL CENTRE LINE COORDINATES ARE TO ACHIEVE 110mm PARALLEL TO THE GLASS PLANE AT THE INTERSECTING POINTS TO GIVE AN EQUIANGLE CONDITION.
THE PERIMETER DIA 89mm RING BEAM SHOULD BE TANGENTIAL TO A VERTICAL LINE FROM THE GLASS EDGE. (THIS MAY MANIFEST AS STEPS TO THE HEIGHTS OF THE TUBE WHEN VIEWED HORIZONTALLY)

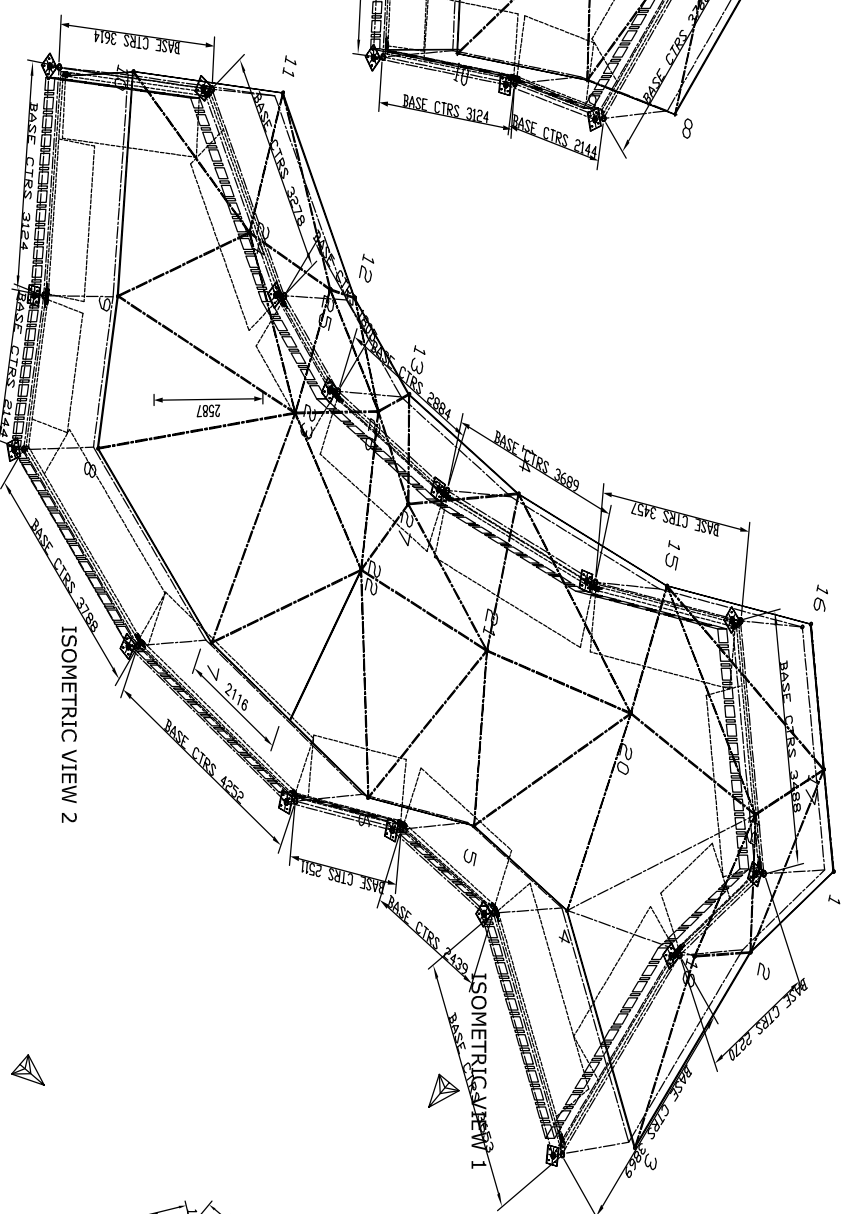

ISOMETRIC VIEW 2

ISOMETRIC VIEW 3

FOR RELATIONSHIP TO SLAB EDGE AND GRIDLINES REFER TO DRAWING GA-607

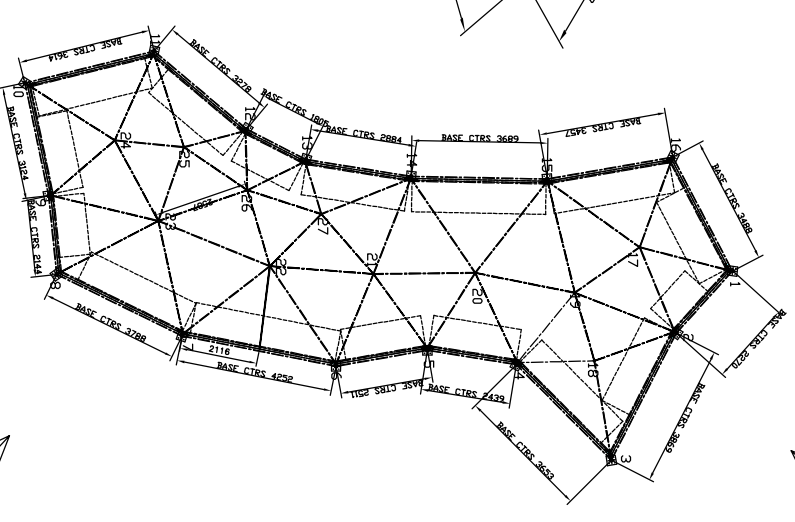
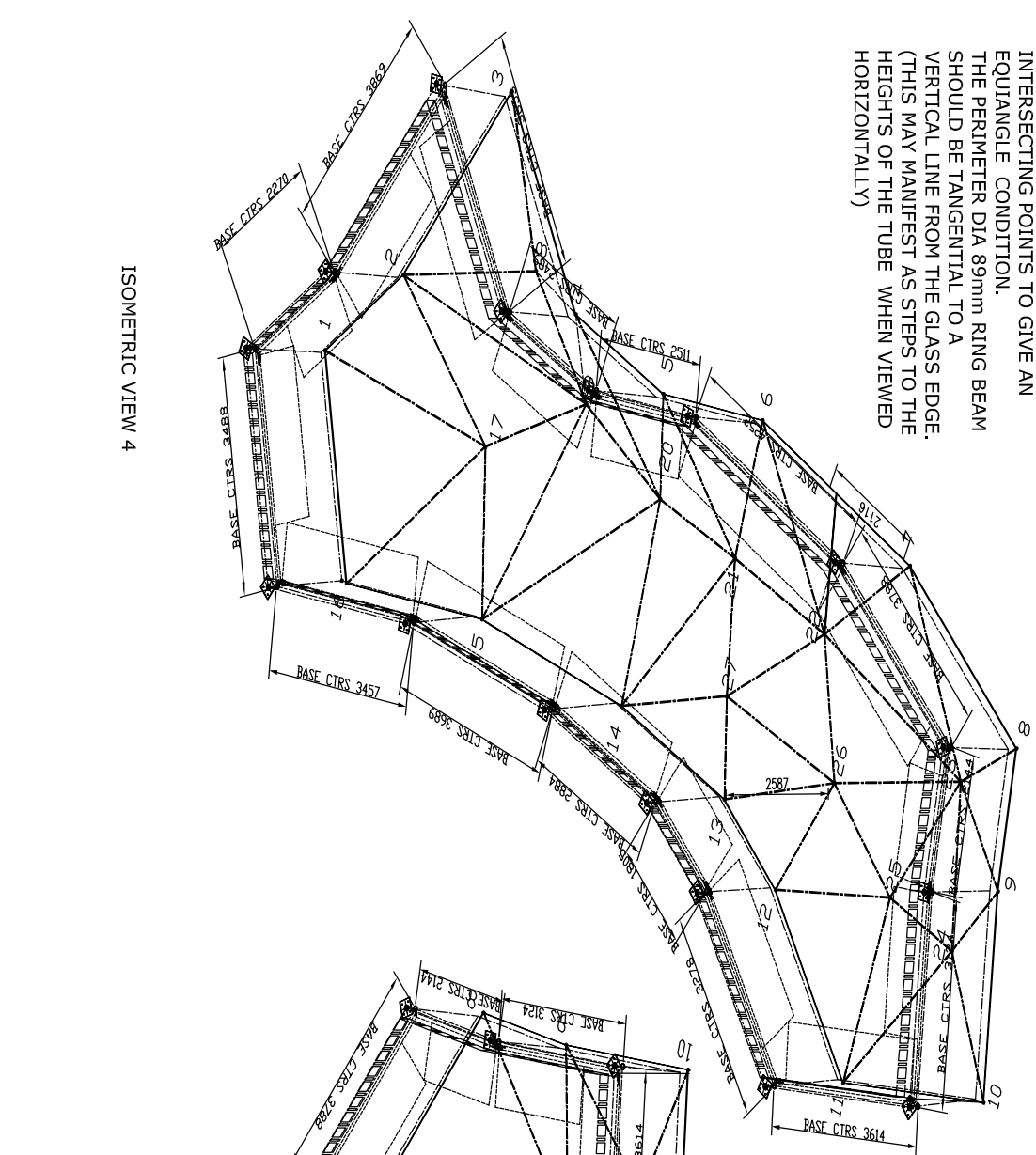
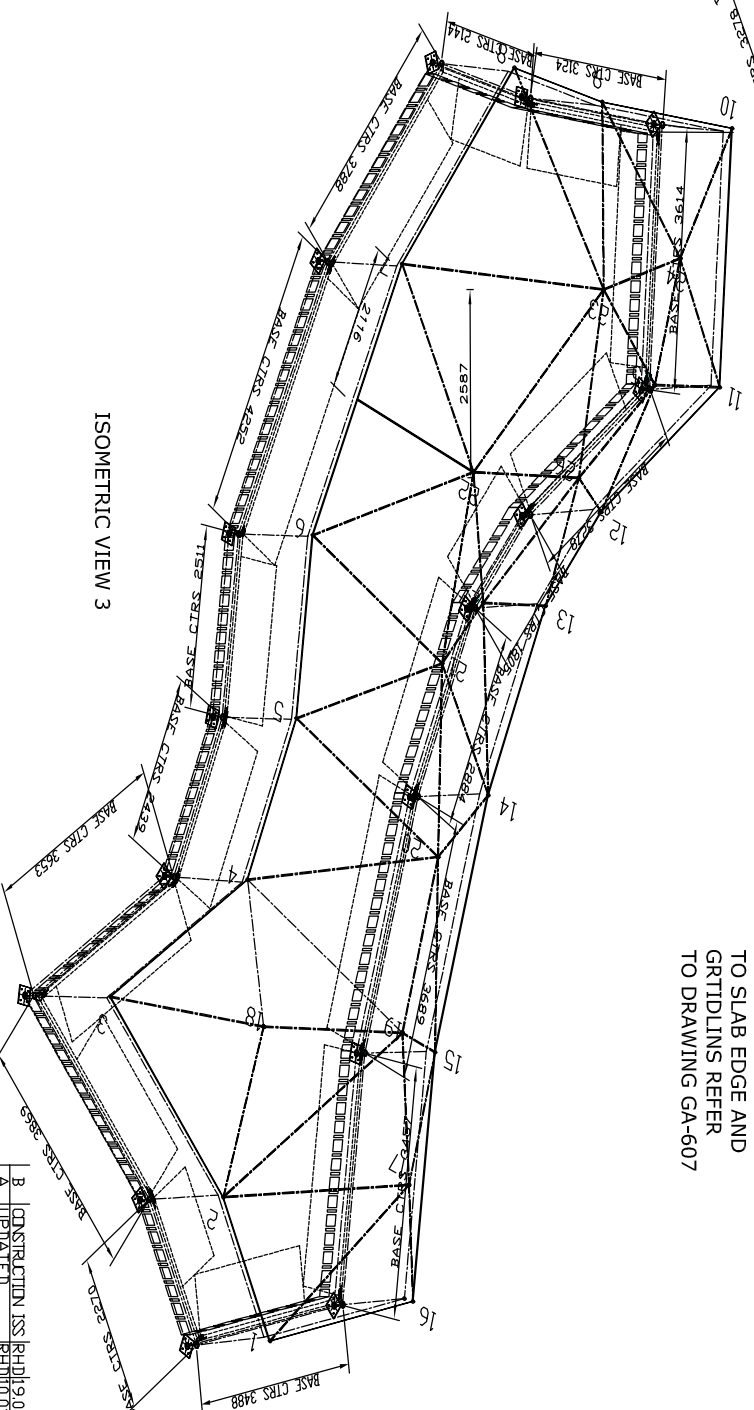

| | |
|-----|-------------------------------|
| B | INSTRUCTION ISS (RHP) 9.01.13 |
| A | DP (RHP) 20.11.13 |
| REV | DESCRIPTION |
| 1 | 21.12.11 |

| | | |
|--|---------------------------|--------------|
| INFORMATION | APPROVAL | CONSTRUCTION |
| Project <i>Oxford Mathematics Building</i> | | |
| Project No. 0788022 | | |
| Format A3 | Drawing No. GA-601 | |
| Scale: 1:20 @ A3 | Revision B | |
| Date 03.12.12 | Checked by - | |
| Drawn by RHD | | |